



Annular ringlight Jumbo 66 mm

## Jumbo Ringlights

### Features:

- Continuous ring of illumination fiber within the housing.
- Active diameter of the bundle is using the entire focal diameter of the 250 watt halogen bulb.
- Mounts directly to 66 mm objective by means of thumb screw.
- Housing made of rugged, black anodized aluminium.
- Fiber bundle protected with flexible metal PVC sheathing.
- Manufactured in the EU.

### Benefits:

- Absolute shadow-free illumination for large area targets (i.e. SMD).
- The Jumbo Ringlight in connection with the KL 2500 LCD delivers 300% more light as the standard ringlight with KL 1500 LCD.
- Large area fluorescence illumination.

Jumbo Ringlights										
Cold light source	Part-No. SCHOTT GLAS	Type	Length	Inner Ø	Outer Ø	Height	Minimum working distance*	Active Ø/ branch	Outer Ø Jacketing	Light source adapter Ø
			L	ID	OD	H	A	b	D	F
KL 2500 LCD only	257 420	Slit 66 mm Ø	1000 mm 43.48 inch	66 mm 2.60 inch	120 mm 4.72 inch	36 mm 1.44 inch	25 mm 0.98 inch	12 mm 0.47 inch	20 mm 0.80 inch	17 mm 0.67 inch

\* Ring lights usable in any working distance above given minimum values.

# Jumbo Ringlights

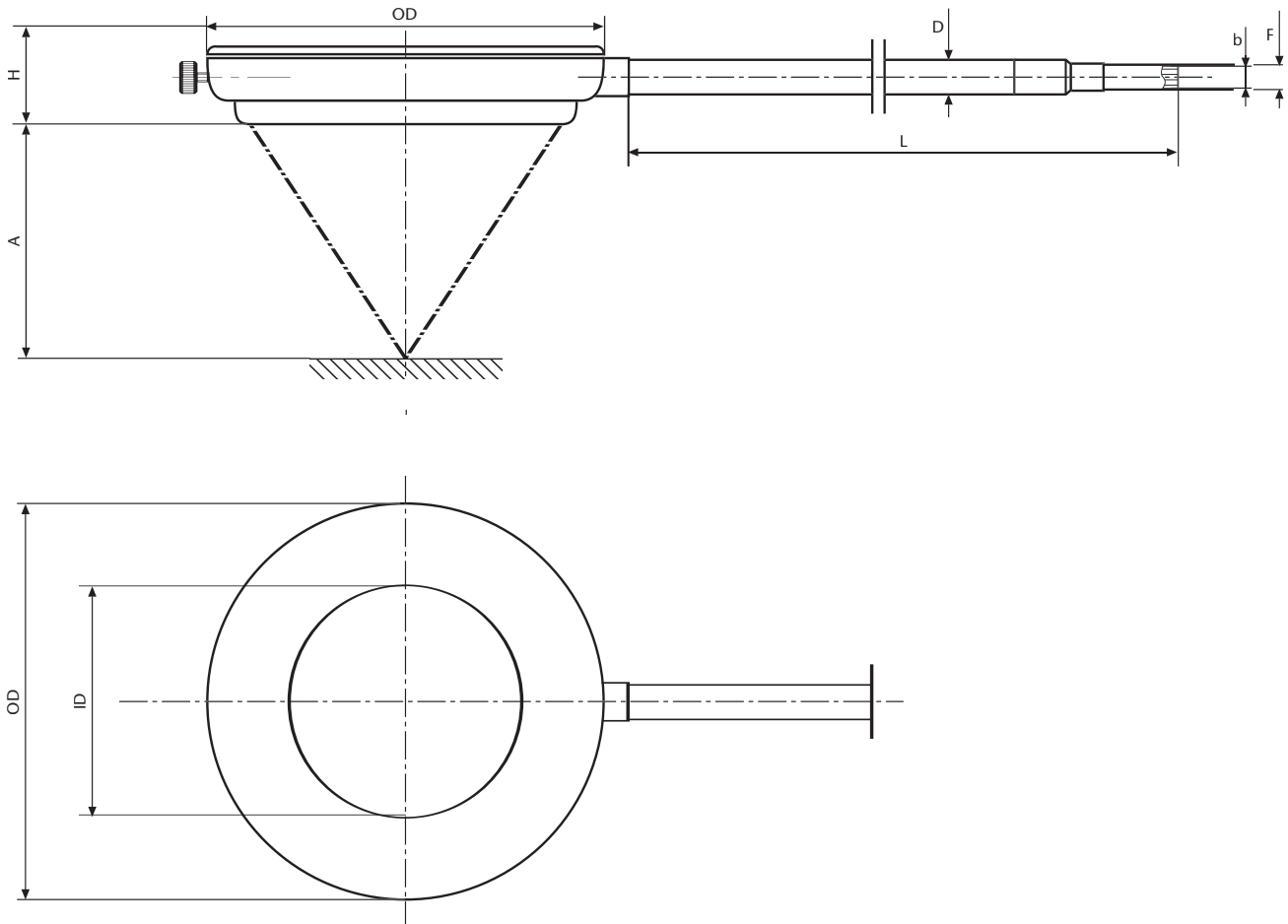

Fiber Optics

**SCHOTT North America, Inc.**

62 Columbus Street

Auburn, NY 13021-3137

USA

Phone: +1315/255-2791

Fax: +1315/255-2695

E-mail: [fiberoptics.auburn@us.schott.com](mailto:fiberoptics.auburn@us.schott.com)

[www.us.schott.com/fiberoptics](http://www.us.schott.com/fiberoptics)

# SCHOTT